

Grandstream Networks, Inc.

126 Brookline Ave, 3rd Floor
Boston, MA 02215. USA
Tel : +1 (617) 566 - 9300
Fax: +1 (617) 249 - 1987

www.grandstream.com



GSC3506

SIP/Multicast Intercom Speaker

Quick Installation Guide



For Certification, Warranty and RMA information,
please visit www.grandstream.com

The GSC3506 is not pre-configured to support or make emergency calls to any type of hospital, law enforcement agency, medical care unit (“Emergency Service(s)”) or any other kind of Emergency Service. You must make additional arrangements to access Emergency Services. It is your responsibility to purchase SIP-compliant Internet telephone service, properly configure the GSC3506 to use that service, and periodically test your configuration to confirm that it works as you expect. It is also your responsibility to purchase traditional wireless or landline telephone services to access Emergency Services.

GRANDSTREAM DOES NOT PROVIDE CONNECTIONS TO EMERGENCY SERVICES VIA THE GSC3506. NEITHER GRANDSTREAM NOR ITS OFFICES, EMPLOYEES OR AFFILIATES MAY BE HELD LIABLE FOR ANY CLAIM, DAMAGE, OR LOSS, AND YOU HEREBY WAIVE ANY AND ALL SUCH CLAIMS OR CAUSES OF ACTION ARISING FROM OR RELATING TO YOUR INABILITY TO USE THE GSC3506 TO CONTACT EMERGENCY SERVICES, AND YOUR FAILURE TO MAKE ADDITIONAL ARRANGEMENTS TO ACCESS EMERGENCY SERVICES IN ACCORDANCE WITH THE IMMEDIATELY PRECEDING PARAGRAPH.

The GNU GPL license terms are incorporated into the device firmware and can be accessed via the Web user interface of the device at my_device_ip/gpl_license. It can also be accessed here: <http://www.grandstream.com/legal/open-source-software>

To obtain a CD with GPL source code information please submit a written request to info@grandstream.com

OVERVIEW

The GSC3506 is a 1-way public address SIP speaker that allows of-fices, schools, hospitals, apartments and more to build powerful public address announcement solutions that expand security and communication. This robust SIP speaker offers crystal clear HD audio functionality with a high-fidelity 30-Watt HD speaker. The GSC3506 support built-in whitelists ,blacklists and greylists to easily block unwanted calls, SIP and multicast paging, group paging and PTT. users can easily sculpt a state-of-the-art security and PA announcement solution. Thanks to its modern industrial design and rich features, the GSC3506 is the ideal SIP speaker for any setting.

PRECAUTIONS

- Do not attempt to open, disassemble, or modify the device.
- Do not expose this device to temperatures outside range of 0 °C to 45 °C in operation and -10 °C to 60 °C in storage.
- Do not expose the GSC3506 to environments outside of the following humidity range: 10-90% RH (non-condensing).
- Do not power cycle your GSC3506 during system boot up or firmware upgrade. You may corrupt firmware images and cause the unit to malfunction.

PACKAGE CONTENTS

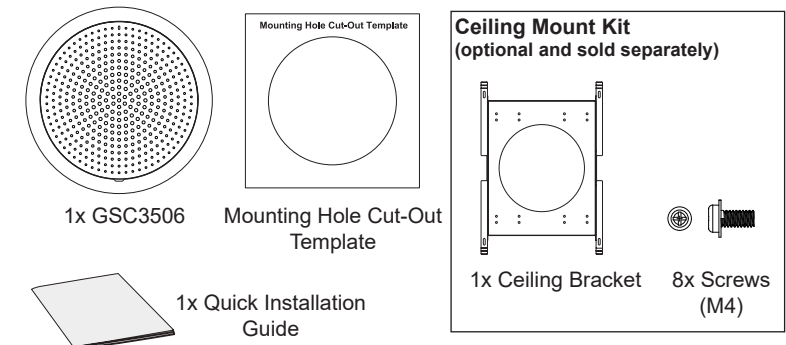

GSC3506 PORTS AND BUTTONS

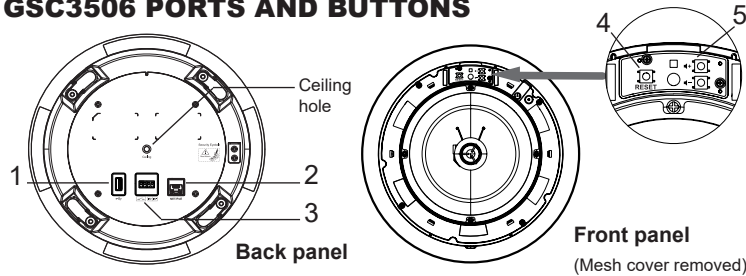

NO.	Port	Label	Description
1		USB Port	USB2.0, External USB Storage
2		NET/PoE	Ethernet RJ45 port (10/100Mbps) supporting PoE/PoE+.
3		2-Pin port	2-pin switch-in input port Alarm-in input port (Access voltage 5V to 12V)
4		Reset	Factory reset button. Press for 10 seconds to reset factory default settings.
5		Volume	Sound Volume buttons.

HARDWARE INSTALLATION

GSC3506 can be mounted on the ceiling or the Boom. Please refer to the following steps for the appropriate installation.

Ceiling Mount

1. Drill a round hole with a diameter of 230mm or use the Mounting Hole Cut-Out Template.

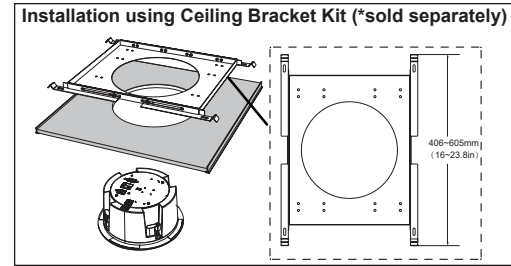
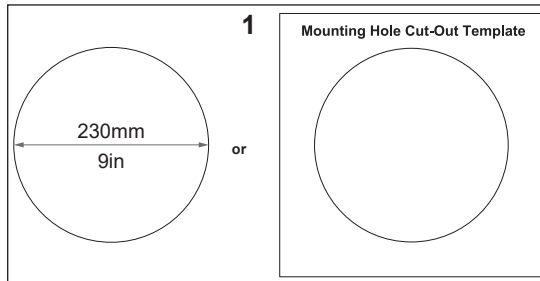

Fix the Ceiling Bracket using the screws from the kit as show in the illustration.

2. To ensure safety, install first the anti-fall ropes, then plug in the Ethernet and 2-pin cables.

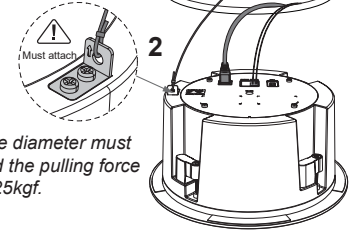

Note: The anti-fall rope diameter must be less than 5mm, and the pulling force must be greater than 25kgf.

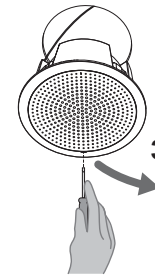

3. Open the front cover with a flat-head screwdriver.

4. Align the device with the hole and push up slowly with two hands.

Warning: Avoid pressing the horn with your hands.

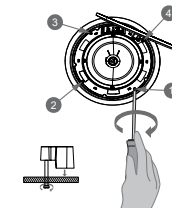
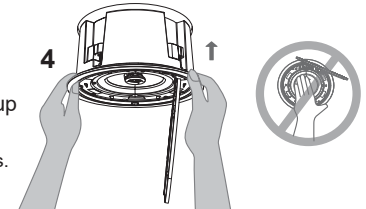

5

5. Use a screwdriver and gently rotate clockwise the screws marked as (1), (2), (3) and (4) in the step 5 illustration.

Warning: If you use an electric drill, make sure to adjust it to the minimum speed gear first.

6. Align the notch on the front cover with the notch on the device, press the whole front cover to ensure that each buckle is fastened.

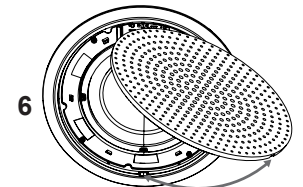

Boom Mount

1. Fix the Boom in the ceiling.

2. To ensure safety, install first the anti-fall ropes.

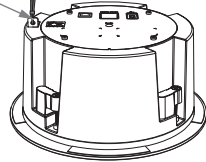
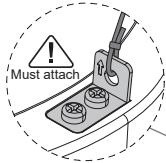

3. Attach the Boom with GSC3506 ceiling hole and rotate to fix it in place.

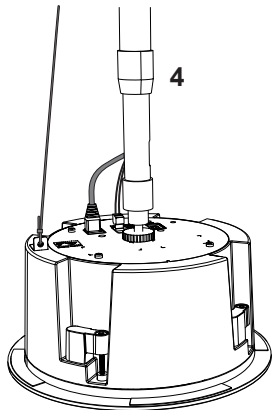

4. Plug in the Ethernet and 2-pin cables.

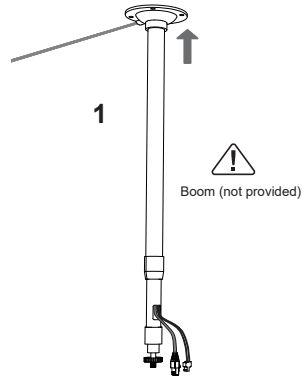

Note: The anti-fall rope diameter must be less than 5mm, and the pulling force must be greater than 25kgf.

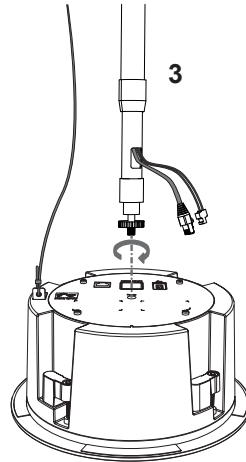

POWERING AND CONNECTING GSC3506

GSC3506 can be powered on using PoE/PoE+ switch or PoE injector using following steps:

Step 1: Plug a RJ45 Ethernet cable into the network port of the GSC3506.

Step 2: Plug the other end into the power over Ethernet (PoE) switch or PoE injector.

Note: It is recommended to use PoE+ power supply to achieve the best audio effect.

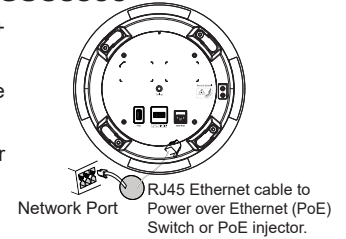

Connecting Wiring Seat

GSC3506 support to connect a "Normal Key" to 2-pin port via Wiring Seat.

Step 1: Take the wiring seat from the install kits.

Step 2: Connect the Normal Key with the wiring seat (as shown in the illustration on the right).

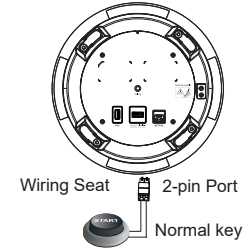

ACCESSING THE CONFIGURATION INTERFACE

A computer connected to the same network as the GSC3506 can discover and access its configuration interface using its MAC address :

1. Locate the MAC address on the MAC tag of the unit, which is on the underside of the device, or on the package.
2. From a computer connected to same network as the GSC3506, type in the following address using the GSC3506's MAC address on your browser: **http://gsc_<mac>.local**

Example: if a GSC3506 has the MAC address C0:74:AD:11:22:33, this unit can be accessed by typing **http://gsc_c074ad112233.local** on the browser.



For more information, please refer to GSC3506 User Manual at: <https://www.grandstream.com/support>